

4

3

2

1

038-00-065
Retaining Ring: Snap, Smalley, Internal, Custom, Ø.923 BORE

241-01-029
Bladder retainer, 011 RC2

210-22-420
Lower Bladder Ring, Snap Ring, 011 RC2

IMPORTANT:
ENSURE RETAINING RING IS FULLY
SEATED INTO GROOVE FULL 360°

820-03-473-KIT
REBOUND ASSY

GREASE:
THIN LAYER
ON INNER AND OUTER SEAL BEADS

TORQUE:
75±5 IN.LB.

GREASE:
THIN LAYER OF SLICK HONEY
ON INNER SURFACE

TORQUE:
75±5 IN.LB.

210-22-391
Bladder, 2011 36_40

CARTRIDGE BODY

GREASE:
THIN LAYER OF SLICK HONEY
ON INNER SURFACE

GREASE:
THIN LAYER OF
SLICK HONEY

TORQUE:
75±5 IN.LB.

820-03-395-KIT
Base Valve Assy

210-22-418
Upper Bladder Ring, 011 RC2

029-08-178
Topcap O-Ring

Topcap

820-03-187
2011 RC2 Adjuster Assy

IMPORTANT:
VERIFY THAT RETAINING RING
IS COMPLETELY SEATED

038-00-059
Retaining Ring, Internal, VHM-14

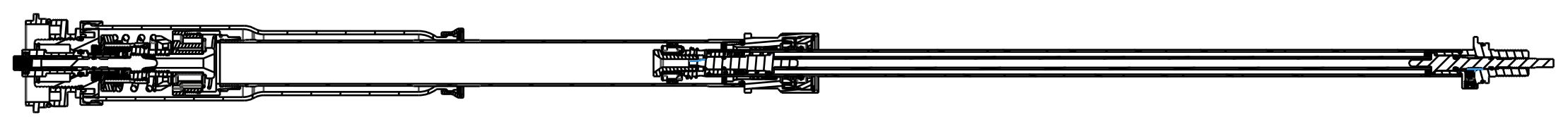

SECTION A-A

PROPRIETARY
THIS DOCUMENT CONTAINS CONFIDENTIAL, PROPRIETARY INFORMATION
THAT IS FOX PROPERTY. DO NOT DISCLOSE TO OR DUPLICATE
FOR OTHERS EXCEPT AS AUTHORIZED BY FOX.

| | | | |
|------------|---|--------------|-----------------|
| | FOX Factory, Inc. | | Ph 831-768-1100 |
| | 130 Hangar Way, Watsonville, CA 95076 USA | | |
| TITLE | 2017 36 RC2 Cartridge | | |
| SIZE | DWG. NO. | C | |
| PLOT SCALE | 0.50:1 | SHEET 1 OF 1 | |

4

3

2

1